

DRAWING TYPE

CUSTOMER DRAWING

MARK

DATE

DESCRIPTION

DESIGN

A

2017.06.12

PROPOSAL

CHEN

B

2020.05.11

UPDATE DRAWING

CHEN

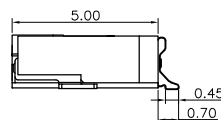
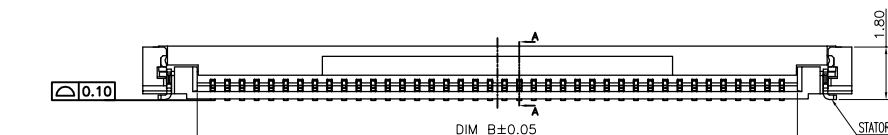
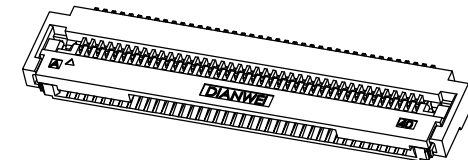
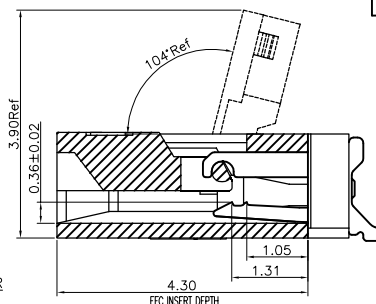
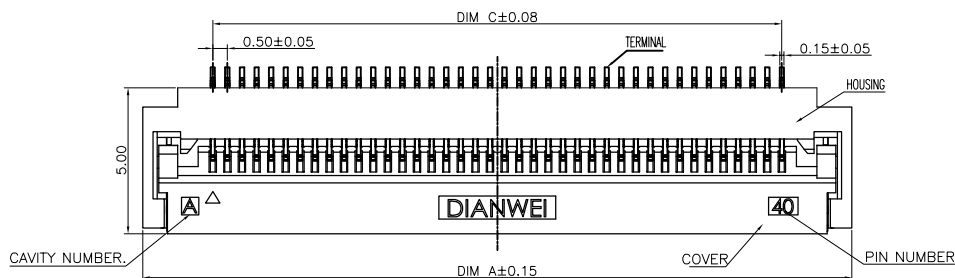

## 1. PART NO. LEGEND:

8.05A0.\*\*\*200

① ② ③ ④ ⑤

①.SERIES NAME:8.05A0=0.5MM FFC/FPC SWING COVER CONNECTOR (H=1.8mm)

②.CONTACT PIN NUMBER:\*\*\*=CONTACT PIN NUMBER

③.CONTACT AREA PLATING SPEC: GOLD PLATING: 2=1~3u";3=5u";4=10u";5=15u"  
SOLDER AREA PLATING SPEC: GOLD PLATING: 2=1~3u";3=5u";4=10u";5=15u"

④.UNSPECIFIED:0=NONSENSE

⑤.UNSPECIFIED:0=NONSENSE

## 2. PERFORMANCE:

2.1: CURRENT RATING: 0.5A/PIN.

2.2: VOLTAGE RATING: 50V (AC/DC).

2.3: CONTACT RESISTANCE: INITIAL VALUE 30mOHM Max,

2.4: INSULATION RESISTANCE: 500MOHM Min.

2.5: DIELECTRIC WITHSTANDING VOLTAGE: 250V AC FOR 1MINUTE;

2.6: DURABILITY: 20 TIMES Min.

2.7: OPERATING TEMPERATURE: -40°C~+85°C

OPERATING HUMIDITY RANGE: 20% TO 85%

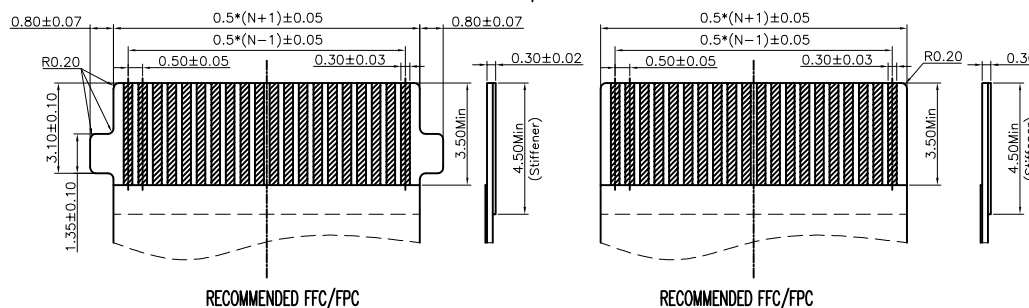
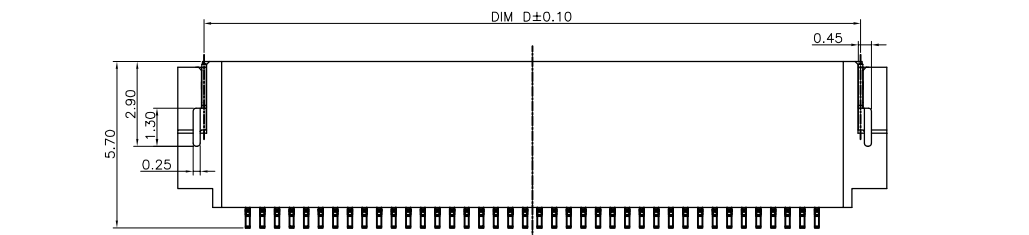

RECOMMENDED FFC/FPC

RECOMMENDED FFC/FPC

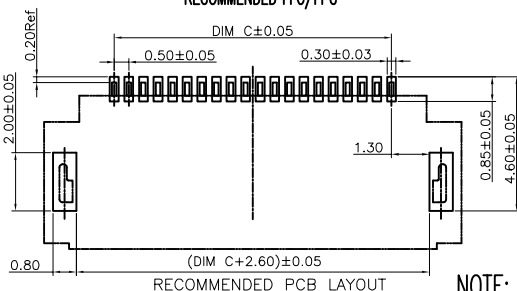

NOTE: ALL RIGHTS RESERVED,BANNED COPY!

Pin No.	P/N	DIM A	DIM B	DIM C	DIM D
4	8.05A0.004200	6.30	2.56	1.50	4.50
8	8.05A0.008200	8.30	4.56	3.50	6.50
10	8.05A0.010200	9.30	5.56	4.50	7.50
12	8.05A0.012200	10.30	6.56	5.50	8.50
20	8.05A0.020200	14.30	10.56	9.50	12.50
24	8.05A0.024200	16.30	12.56	11.50	14.50
30	8.05A0.030200	19.30	15.56	14.50	17.50
34		21.30	17.56	16.50	19.50
40	8.05A0.040200	24.30	20.56	19.50	22.50
41		24.80	21.06	20.00	23.00
42	8.05A0.042200	25.30	21.56	20.50	23.50
45	8.05A0.045200	26.80	23.06	22.00	25.00
50	8.05A0.050200	29.30	25.56	24.50	27.50
51		29.80	26.06	25.00	28.00
54	8.05A0.054200	31.30	27.56	26.50	29.50
56	8.05A0.056200	32.30	28.56	27.50	30.50
60	8.05A0.060200	34.30	30.56	29.50	32.50
61		34.80	31.06	30.00	33.00
64	8.05A0.064200	36.30	32.56	31.50	34.50
65		36.80	33.06	32.00	35.00
68	8.05A0.068200	38.30	34.56	33.50	36.50
70		39.30	35.56	34.50	37.50
71		39.80	36.06	35.00	38.00
75		41.80	38.06	37.00	40.00
80	8.05A0.080200	44.30	40.56	39.50	42.50
81		44.80	41.06	40.00	43.00
85		46.80	43.06	42.00	45.00
90		49.30	45.56	44.50	47.50
95		51.80	48.06	47.00	50.00
96	8.05A0.096200	52.30	48.56	47.50	50.50
100	8.05A0.100200	54.30	50.56	49.50	52.50
128		68.30	64.56	63.50	66.50

NO.	COMPONENTS	MATERIALS	FINISH/COLOR	SPECIFICATION	QUANTITY
4	STATOR	PHOSPHOR BRONZE			2
3	TERMINAL	PHOSPHOR BRONZE			POSITIONS
2	COVER	THERMOPLASTIC UL94V-0	BLACK		1
1	HOUSING	THERMOPLASTIC UL94V-0	NATURAL		1

DIANWEI

东莞市钿威电子科技有限公司

DONGGUAN DIANWEI ELECTRONIC TECHNOLOGY CO., LTD

Tel: +86-769-8788 8322 Fax: +86-769-8788 8321 E-mail: dianwei@188.com Http://www.dianwei.cn

UNLESS OTHERWISE SPECIFIED TOLERANCE

ANG	TOL	DIM	TOL
.X	±3.0°	.X	±0.20
.XX	±2.0°	.XX	±0.10
.XXX	±1.0°	.XXX	±0.05

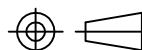

DRAWING NO

8.05A0-C

PART NAME:

0.5MM FFC/FPC SWING CONNECTOR(H=1.8mm)

PART NO.

8.05A0.\*\*\*200

APPROVED

VERIFIED

DESIGN

CHEN

DATE

UNITS

SCALE

PAGE

REV

2020.05.11

mm

1:1

1/1

B

QP-04-33-B